

ShieldVIP Insulation

Description

ShieldVIP is a vacuum insulated panel used in flat roof applications which has a thermal conductivity of 0.0061 W/mK.

The insulation is compacted in order to provide an exceptional thermal performance. It is installed with an XPS infill to provide protection to the board, and the additional underlay/overlay provides further thermal performance to the build up.

The use of this system is mainly to minimise the depth of insulation needed on areas with restricted heights such as door thresholds, particularly on terrace areas.

Manufactured in accordance with ISO 9001 : 2015 and ISO 14001 : 2015.

Features & Benefits

- Non-combustible
- Heat resistant up to 80 °C
- Moisture resistant up to 60%
- Contains no harmful fibres and can be largely recycled

Installation

Must be installed in accordance with manufacturer's recommendations. Contact us for further information and compatibility.

Disclaimer

The evolution of new product design is continuous and information is subject to change without notice. Customers should check with the supplier to ensure that they have the latest details. Shield Membranes reserve the right to amend the technical information as deemed necessary and in accordance with the relevant national and international standards without notice.

PRODUCT INFORMATION	
Thermal Conductivity	VIP 0.0061 W/mK
Thermal resistance	3.28 m ² K/W at a thickness of 20mm
Thermal transmittance	0.305 W/m ² K at a thickness of 20mm
Compressive strength	200 Kpa
R-value	6.67 W/m ² K
Density	160 - 210 kg/m ³
Thickness (mm)	20 - 25 - 30 - 40
Available sizes (mm)	1300 x 600 1200 x 600 1000 x 600 600 x 600 600 x 500 600 x 400 600 x 200 400 x 300
Fixing	Ballasted

Typical Build Ups

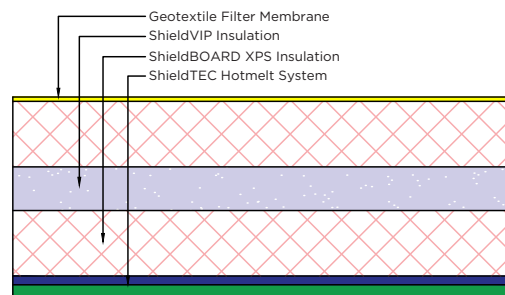

Using XPS

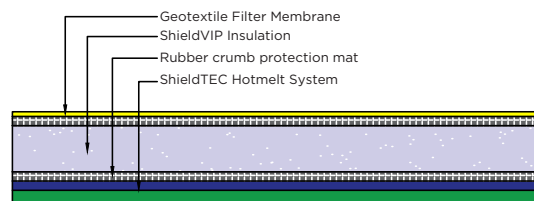

Using Rubber Crumb

0207 740 9279 | www.shieldmembranes.com | info@shieldmembranes.com

“You’re protected with Shield on your side”



SHIELD MEMBRANES

“You’re protected with Shield on your side”



NFRC

LEADING ROOFING EXCELLENCE

